



HEAVY DUTY TABLE DRAWER

Features

- Removable insert for easy cleanup
- Smooth operation, ball bearing slides
- Durable welded construction
- Install easily with any GSW work table
- Stainless steel pan included
- 200 lbs load capacity



Description **Heavy Duty Table Drawer**

This drawer offers an incredibly convenient place to store all of your go-to tools. It's spacious, easy-to-install design combines with smooth, reliable operation to provide you with a valuable addition to your workstation without breaking the bank. It is the perfect fit for 30" wide and 36" long and up work tables.

Plan View **DA-1520**

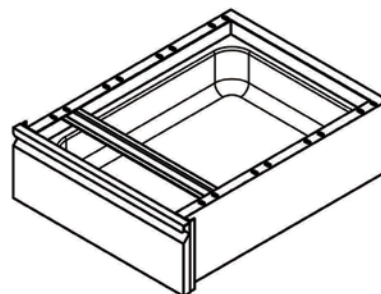
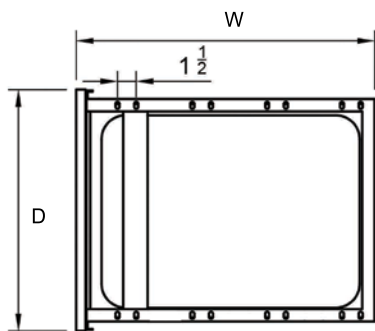

Hang under work table

| Order No. | D x W x H (in) | Pan Inner Space (in) | Pan Model | G. W. (lb) | Qty. |
|-----------|---------------------|----------------------|-----------|------------|------|
| DA-1320 | 16-1/4 x 23 x 6-3/4 | 11-3/4 x 20 x 5 | | 19 | 1 |
| DA-1520 | 19-1/4 x 23 x 6-3/4 | 14-1/2 x 20 x 5 | DA-1520P | 25 | 1 |
| DA-2020 | 24-7/8 x 23 x 6-3/4 | 20 x 20 x 5 | DA-2020P | 36 | 1 |



Features

- Removable insert for easy cleanup
- Smooth operation, ball bearing slides
- Durable welded construction
- Install easily with any GSW work table
- Stainless steel pan included
- 2 Tiers Drawer set
- 200 lbs load capacity



Description **Heavy Duty 2 Tiers Table Drawer**

This drawer offers an incredibly convenient place to store all of your go-to tools. It's spacious, easy-to-install design combines with smooth, reliable operation to provide you with a valuable addition to your workstation without breaking the bank. It is the perfect fit for 30" wide and 36" long and up work tables.

Plan View **DA-2H1520**

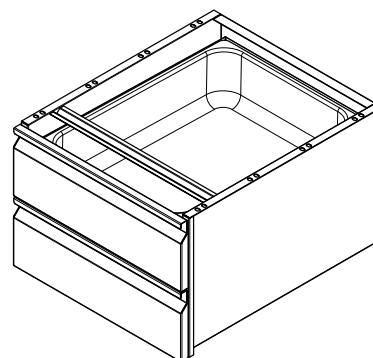
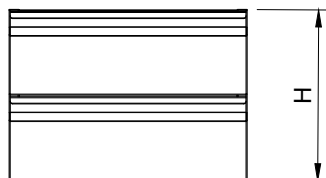
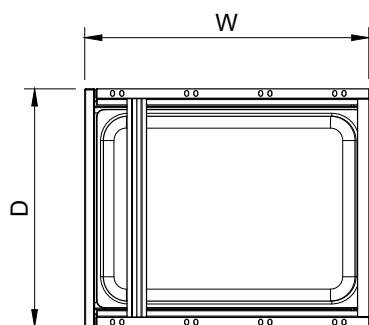

Hang under work table

| Order No. | D x W x H (in) | Pan Inner Space (in) | Pan Model | G. W. (lb) | Qty. |
|-----------|----------------------|----------------------|-----------|------------|------|
| DA-2H1520 | 19-1/4 x 23 x 13-3/4 | 14-1/2 x 20 x 5 | | 50 | 1 |
| DA-2H2020 | 24-7/8 x 23 x 13-3/4 | 20 x 20 x 5 | | 72 | 1 |



Features

- Removable insert for easy cleanup
- Smooth operation, ball bearing slides
- Durable welded construction
- Install easily with any GSW work table
- Stainless steel pan included
- 3 Tiers Drawer set
- 200 lbs load capacity



Description **Heavy Duty 3 Tiers Table Drawer**

This drawer offers an incredibly convenient place to store all of your go-to tools. It's spacious, easy-to-install design combines with smooth, reliable operation to provide you with a valuable addition to your workstation without breaking the bank. It is the perfect fit for 30" wide and 36" long and up work tables.

Plan View **DA-3H1520**

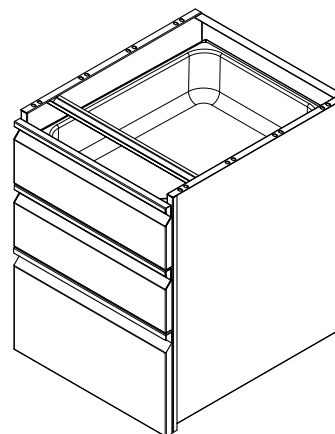
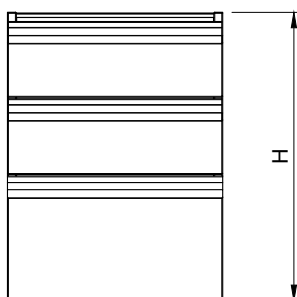
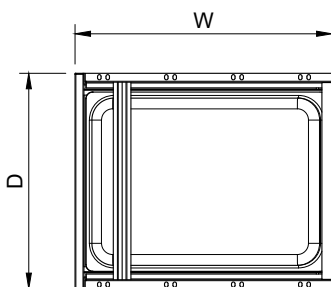

Sit on top of work table undershelf

| Order No. | D x W x H (in) | Pan Inner Space (in) | Pan Model | G. W. (lb) | Qty. |
|-----------|----------------------|----------------------|-----------|------------|------|
| DA-3H1520 | 19-1/4 x 23 x 25-1/8 | 14-1/2 x 20 x 5 | | 73 | 1 |
| DA-3H2020 | 24-7/8 x 23 x 25-1/8 | 20 x 20 x 5 | | 104 | 1 |



HEAVY DUTY TABLE DRAWER PAN

Features

- Full size, 4" deep steam table pan
- Durable stainless steel
- Strong, tapered corners for easy scooping and pouring
- Built to last through heavy commercial use



Description **Heavy Duty Table Drawer Pan**

Made from durable stainless steel, giving you a long lasting workhorse that can hold up against the busiest of kitchens compared to higher gauge pans. This pan is built to last through heavy commercial use. It features an attractive and stylish finish. The smooth, bright construction fits in with any traditional or contemporary service station.

Plan View **DA-1520P**

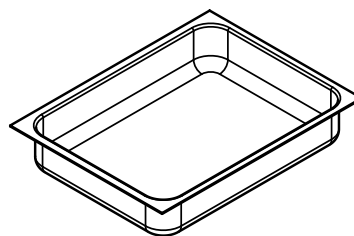
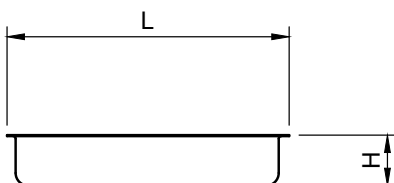
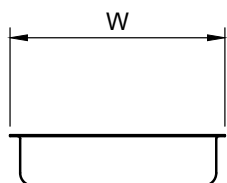

| Order No. | Pan size D x W x H (in) | For Drawer Model | G. W. (lb) | Qty. |
|-----------|-------------------------|------------------|------------|------|
| DA-1520P | 15 x 20 x 5 | DA-1520 | 5 | 1 |
| DA-2020P | 20 x 20 x 5 | DA-2020 | 6 | 1 |