



## UNDERBAR SINK WITHOUT DRAINBOARD

### Features

- All welded stainless steel construction
- 2" thick x 3-1/4" height backsplash, 4" center faucet holes
- Stainless steel legs with adjustable plastic bullet feet
- 1" NPS drain with 7-1/2" removable overflow tube included (x3)
- 1-3/8" strain opening
- Designed for a wash, rinse, and sanitize operation
- Recommended: 4" wall mounted faucet & 8" spout

#### Included Item:

AA-144-8



AA-148-8



#### Recommended Faucet:

AA-401G & AA-008G



### Description Underbar Sink Without Drainboard

This durable, stainless steel bar sink boasts three separate compartments to help you keep up with the demand for glassware at your bar. The two drainboards can be used for collecting dirty glasses on one end and drying them on the other.

The three standard sink bowls is great for a standard wash, rinse, and sanitize operation at your bar. This standard industry practice helps ensure that your glassware is always clean and ready to go for new customers. Each bowl is 10" deep, allowing you to wash even your tallest beer glasses and pitchers.

### Plan View SE10143DNB

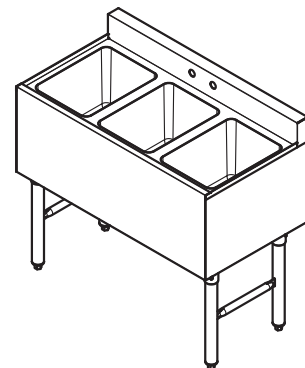
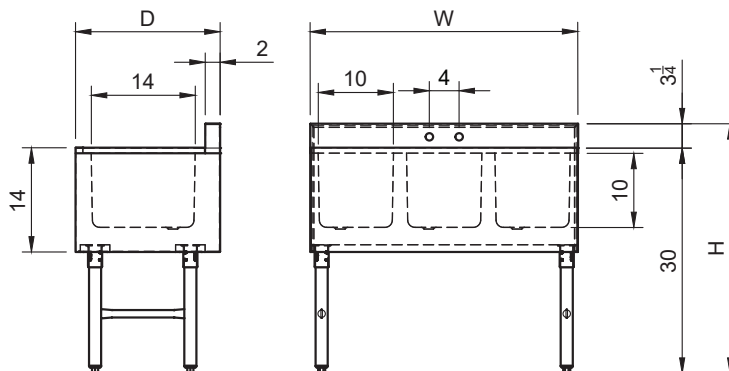

Order No.	D x W x H (in)	Description	G. W. (lb)	Qty.
SE10141DNB	19-1/2 x 12 x 33-1/4	One Sink Bowl Underbar Sink	42	1
SE10142DNB	19-1/2 x 24 x 33-1/4	Two Sink Bowls Underbar Sink	55	1
SE10143DNB	19-1/2 x 36 x 33-1/4	Three Sink Bowls Underbar Sink	72	1